



HELLO FELLOW ANIMAL LOVER,

Animal relinquishments are nothing new for Adopt-A-Pet, nor for any animal shelter. However, since 1977, Adopt-A-Pet has grown immensely and has become one of the most respected and successful shelters in Michigan. Because of this, when people must relinquish their animals, they know they are coming to an organization that will give them the love, caring or training they deserve before finding their new home. And this year, people are asking Adopt-A-Pet to take animals in at an alarming rate.

In 2006, Adopt-A-Pet went from a 1,500 sq. ft. building with no property and no room for growth to an over 10,000 sq. ft. building on almost 9 acres. While in this space, Adopt-A-Pet has saved more than 22,000 animals. Unfortunately, one of the top reasons animals are relinquished to shelters is due to lack of training or behavior concerns which always takes a LOT of extra time. Once in the shelter those concerns typically become worse, leading to behaviors that can be destructive, cause medical issues and create lasting effects if not addressed. Adopt-A-Pet invested in one of our staff to become a Certified Dog Trainer and developed training and enrichment programs to help the animals while they are in our care, but we can do more! We can make the program more robust! To do so, Adopt-A-Pet has the vision to build a state-of-the-art Training and Enrichment Center. This center can allow groups of dogs to have a year-round indoor play area, space for group training, enrichment for dogs who need socialization and basic training for puppies in group settings. This will ensure the dogs are healthier in our care and will be more adjusted in their new homes with less likelihood of being relinquished.

Dudley, a 10-month-old Labradoodle, was brought in due to the owners not being able to handle him. After a few days at Adopt-A-Pet, we understood. This poor boy had never been provided any kind of structure or guidance on how to be a canine companion. He pulled and bit at the leash, jumped up on people, dragged volunteers down and had never been told “no.” Not being told “no” wreaks havoc on a dog’s mental well-being. He would get very frustrated and lose all confidence. Our trainer developed a twice a day training plan for all staff to follow. Unfortunately, Dudley’s regime was often interrupted by poor weather. Many days it was much too cold, icy, or snowy to have his training sessions, thus taking Dudley’s training much longer than anticipated. Ultimately, it took a few months, but soon, Dudley was a confident, happy-go-lucky, well-behaved boy. We were much more comfortable with his adoption because of the focused training he received. If Adopt-A-Pet had a Training and Enrichment Center, Dudley’s twice a day training could have continued uninterrupted, allowing him to find his new home sooner.



DUDLEY



We have the opportunity to save more lives with a Training and Enrichment Center.

This new center will allow more animals to be worked with at one time, a consistent space that can be used every day, all year round and puppy classes can be held. One hundred percent of the dogs coming into Adopt-A-Pet's care will benefit from such a center during their stay, and they will be better adjusted in their new homes due to being trained.

Our goal is to build this Training and Enrichment Center debt free! The new center will cost \$500,000 to design, build and furnish. We will use any donated material we are able to secure. We will also use this center to hold fundraising venues which will bring in much-needed funds.

ALL donations, no matter the amount, are welcome to start this journey with us. You have a unique opportunity to leave your incredible legacy with your support of the new center.

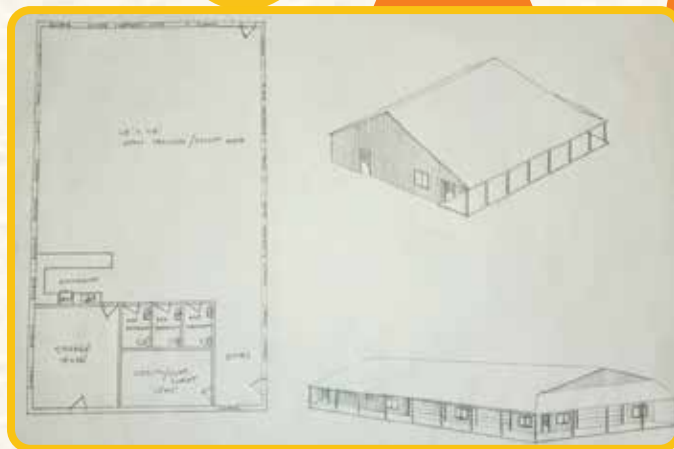

Preliminary Drawing

\$10,000

NAME OR MEMORIAL
ON THE WALL

\$25,000

NAME A ROOM
IN THE NEW BUILDING

\$100,000

NAME ON
THE PATIO

\$250,000

NAME THE
NEW BUILDING!!

ALL THE ANIMALS OF ADOPT-A-PET, INCLUDING THE FUTURE ANIMALS, APPRECIATE YOU. I LOOK FORWARD TO THE OPPORTUNITY TO ANSWER ANY QUESTIONS YOU MIGHT HAVE.



**PLEASE DONATE TODAY
VIA THE ENCLOSED
ENVELOPE, AT
ADOPTAPETFENTON.COM
OR OUR QR CODE.**

Jody Maddock

Jody Maddock, Director